

HALF HOLES FOR  
1/4 x 20 TPI SCREWS  
4 PLACES

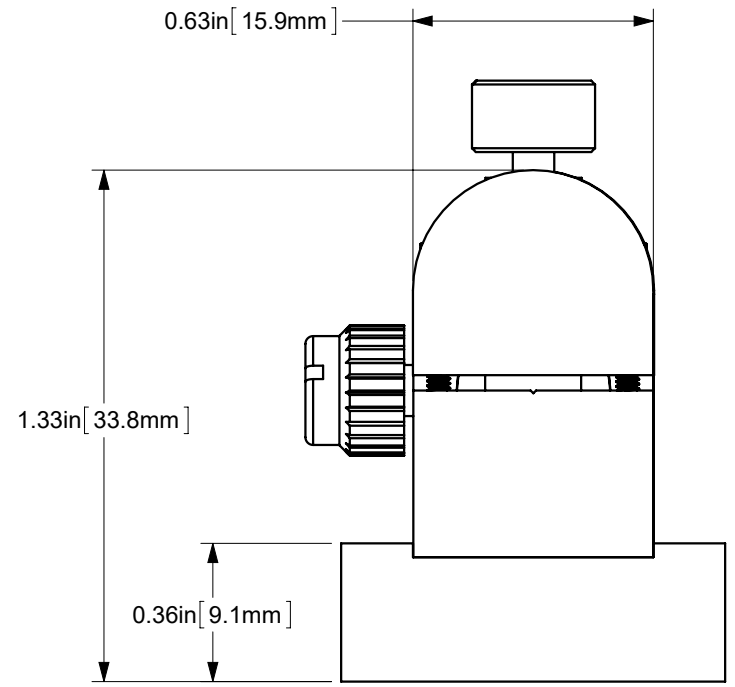

A		N/A		ORIGINAL ISSUE		P.S.		02-JAN-2019																																						
REV.	ECR REF#	DESCRIPTION	ENG. BY	DATE																																										
DRAWN BY: P. Summers		DATE: 1/16/2019	UNLESS NOTED OTHERWISE, DIMENSIONS ARE IN INCHES. MILLIMETERS ARE IN SQUARE BRACKETS, AND TOLERANCES APPLY AS SHOWN BELOW.							PART BARCODE #																																				
CHECKED BY:		DATE:	<table border="1"> <tr><th colspan="3">INCHES</th></tr> <tr><td>BASIC DIMENSION</td><td>.XX</td><td>.XXX</td></tr> <tr><td>BELOW 4</td><td>±.01</td><td>±.005</td></tr> <tr><td>OVER 4</td><td>±.02</td><td>±.01</td></tr> <tr><th colspan="3">MILLIMETERS</th></tr> <tr><td>BASIC DIMENSION</td><td>X</td><td>.XX</td></tr> <tr><td>BELOW 101.6</td><td>±.25</td><td>±.10</td></tr> <tr><td>OVER 101.6</td><td>±.50</td><td>±.20</td></tr> <tr><th colspan="3">ANGULAR DIMENSIONS</th></tr> <tr><td>BASIC DIMENSION</td><td>X</td><td>X.X</td></tr> <tr><td>ALL ANGLES</td><td>±2.5°</td><td>±0.5°</td></tr> </table>							INCHES			BASIC DIMENSION	.XX	.XXX	BELOW 4	±.01	±.005	OVER 4	±.02	±.01	MILLIMETERS			BASIC DIMENSION	X	.XX	BELOW 101.6	±.25	±.10	OVER 101.6	±.50	±.20	ANGULAR DIMENSIONS			BASIC DIMENSION	X	X.X	ALL ANGLES	±2.5°	±0.5°	219 WESTBROOK ROAD OTTAWA, ONTARIO CANADA K0A 1L0		2575	
INCHES																																														
BASIC DIMENSION	.XX	.XXX																																												
BELOW 4	±.01	±.005																																												
OVER 4	±.02	±.01																																												
MILLIMETERS																																														
BASIC DIMENSION	X	.XX																																												
BELOW 101.6	±.25	±.10																																												
OVER 101.6	±.50	±.20																																												
ANGULAR DIMENSIONS																																														
BASIC DIMENSION	X	X.X																																												
ALL ANGLES	±2.5°	±0.5°																																												
MIS CHECKED BY:		DATE:	<table border="1"> <tr><th colspan="3">MILLIMETERS</th></tr> <tr><td>BASIC DIMENSION</td><td>X</td><td>.XX</td></tr> <tr><td>BELOW 101.6</td><td>±.25</td><td>±.10</td></tr> <tr><td>OVER 101.6</td><td>±.50</td><td>±.20</td></tr> <tr><th colspan="3">ANGULAR DIMENSIONS</th></tr> <tr><td>BASIC DIMENSION</td><td>X</td><td>X.X</td></tr> <tr><td>ALL ANGLES</td><td>±2.5°</td><td>±0.5°</td></tr> </table>							MILLIMETERS			BASIC DIMENSION	X	.XX	BELOW 101.6	±.25	±.10	OVER 101.6	±.50	±.20	ANGULAR DIMENSIONS			BASIC DIMENSION	X	X.X	ALL ANGLES	±2.5°	±0.5°	DESC.		MANUAL POLARIZATION CONTROLLER ALL FIBER													
MILLIMETERS																																														
BASIC DIMENSION	X	.XX																																												
BELOW 101.6	±.25	±.10																																												
OVER 101.6	±.50	±.20																																												
ANGULAR DIMENSIONS																																														
BASIC DIMENSION	X	X.X																																												
ALL ANGLES	±2.5°	±0.5°																																												
APVD BY:		DATE:	PART NO.							REV																																				
PROJECTION:									FPC-100		A																																			
CONFIDENTIAL THIS PRINT IS THE EXCLUSIVE PROPERTY OF OZ OPTICS AND MUST BE RETURNED UPON REQUEST. UNAUTHORIZED USE, MANUFACTURE OR REPRODUCTION IN WHOLE OR IN PART IS PROHIBITED.		SURFACE FINISH		MILLED 125u		PROFILED 63u		SIZE: B		DWG.# 3000-0537		SHEET 1 OF 1		SCALE: 2:1																																

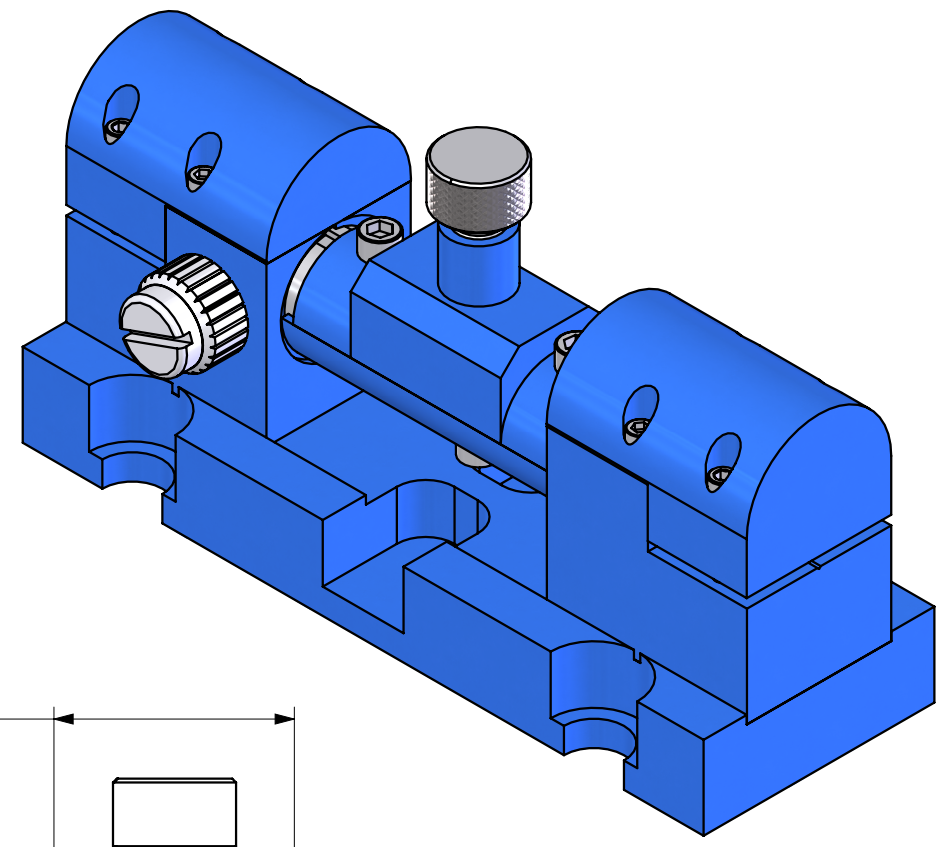